

# OPERATOR'S MANUAL

## Smart Care<sup>®</sup> TRIO

### Rug Shampooer & Pile Lifter



Photo of Machine	1
Assembly	2
Operation	3
Brush Selection and Removal/Replacement	3
Cleaning Instructions	4
Maintenance	5
Troubleshooting	6
Technical Details	7
SAFETY ADVICE	8

**Please read Operator's Manual completely before using the machine and pay close attention to the safety advice.**

○○○ PROGENTA

Please record identification numbers below. You should provide these numbers when ordering parts and accessories to insure accuracy.

Date of Purchase

Model No:

Serial No:

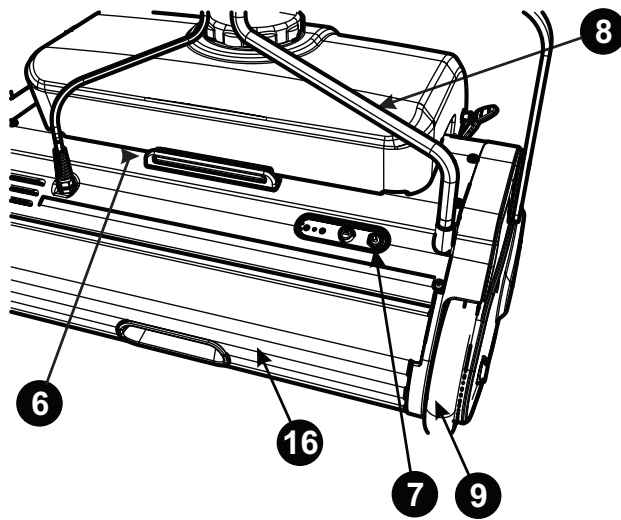
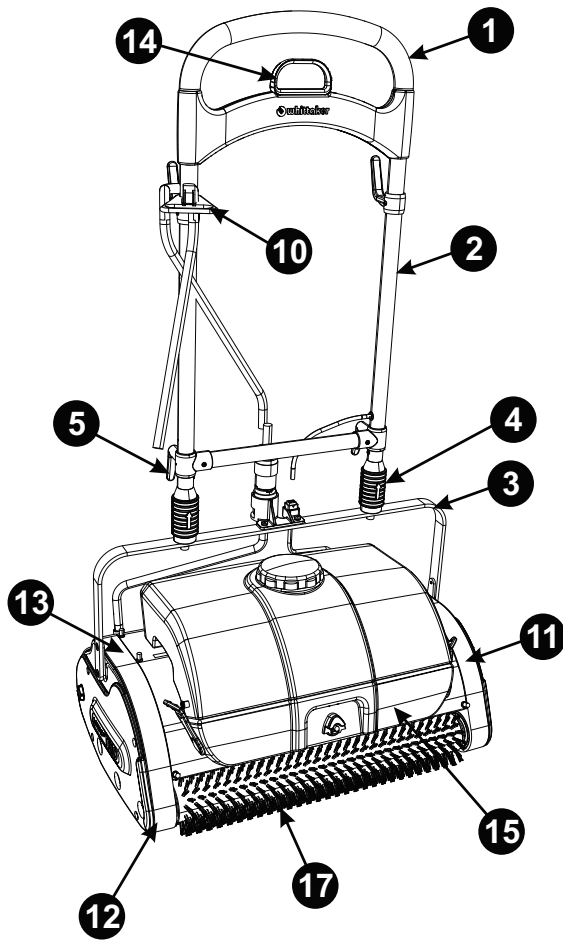

- 1- Handle -Top Loop
- 2- Handle Assembly
- 3- Lower Handle
- 4- Connector Handle Assembly
- 5- Extension Cord Hook - Plastic (4)
- 6- Nameplate (Under solution tank)
- 7- Motor Protector Breaker
- 8- Power cord-from base
- 9- Transport wheels (2)
- 10- Cable Retainer
- 11- Gear Side Housing
- 12- Idle Side Housing
- 13- Machine Base
- 14- Pull Handle
- 15- Fresh Water Tank
- 16- Collection Hopper
- 17- Brush

All information, illustrations and specifications in this manual are based on the latest information at the time of publication. The right is reserved to make changes at any time without notice.

# SET-UP INSTRUCTIONS

Your Smart Care<sup>®</sup> TRIO machine is designed to give you excellent performance and long life. This machine is ideal to clean carpeted floors in facilities like offices, schools, hospitals, airports, hotels, casinos, and similar commercial applications. Reading this manual will help you get the most from its many features.

## ASSEMBLY:

In the two boxes you will find: machine base (shipped with brushes installed), and the handle assembly.

- A. Remove the machine base from the packing and place it squarely on the floor. To do this, raise the bottom handle upright until it locks.
- B. Remove the handle assembly from the packing and place it on a scratch - free surface.
- C. Place assembled handle on handle cone assembly indicated by the arrow in fig. Plastic cord holders should face towards rear of machine, the same as large cord hook.

Be sure the connector assembly is locked in completely or the connectors may break and possibly cause damage to the locking mechanism.

To attach the handle, grasp the ribbed plastic connector (1) at the base of the handle, align with the two cones on the lower handle bar, press down and turn clockwise until it clicks into place. To remove handle, turn counter-clockwise and lift up.

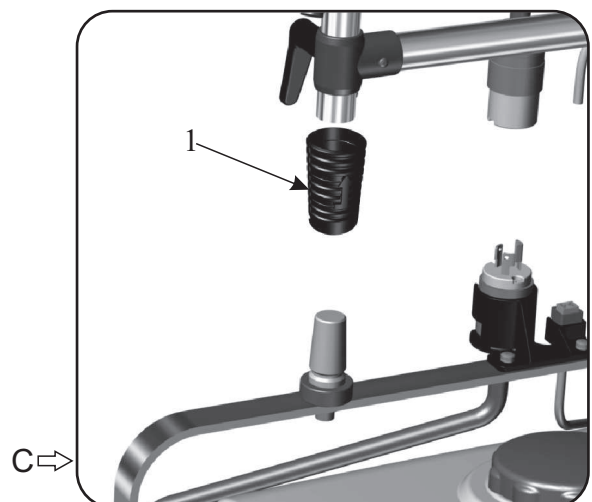
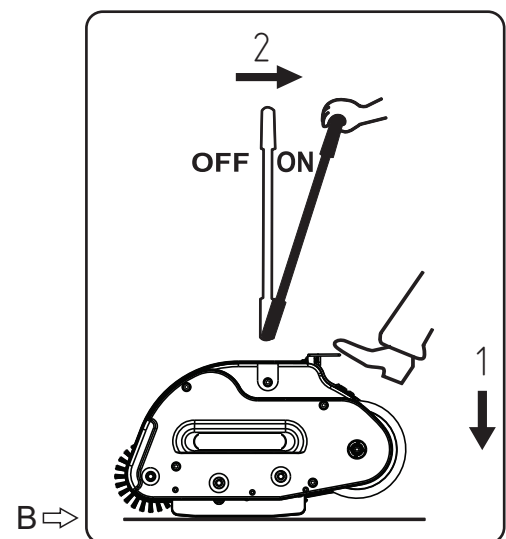
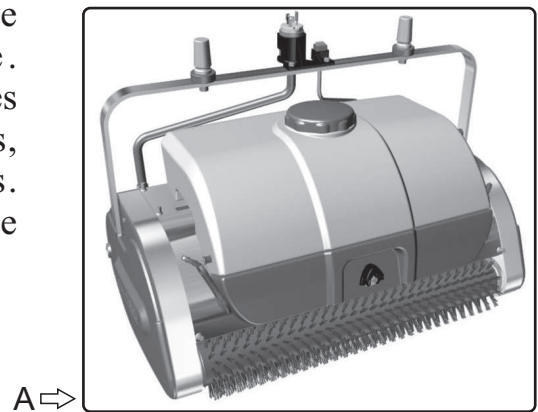

# Smart Care<sup>®</sup> TRIO OPERATION

- A. Move the assembled machine to the work location.
- B. Fill solution tank with desired CRYSTAL<sup>®</sup> cleaning solution.
- C. Connect power cord to grounded outlet.
- D. Press the pedal while lowering the handle backwards.
- E. Slowly lower handle. This reduces the initial startup friction.
- F. To turn off the machine, return the handle to its upright and locked position.

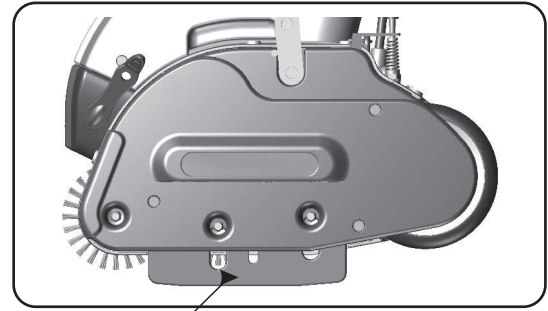

Lifting Plate

## BRUSH REMOVAL:

- A. **Unplug power cord.**
- B. Tilt machine back on its wheels until handle rests on the floor.
- C. With a finger, push axles outwards and pull out. No tools are required if machine is kept clean.

**Note:** Brushes should be removed and rotated end-to-end regularly (every 2-3 hours).

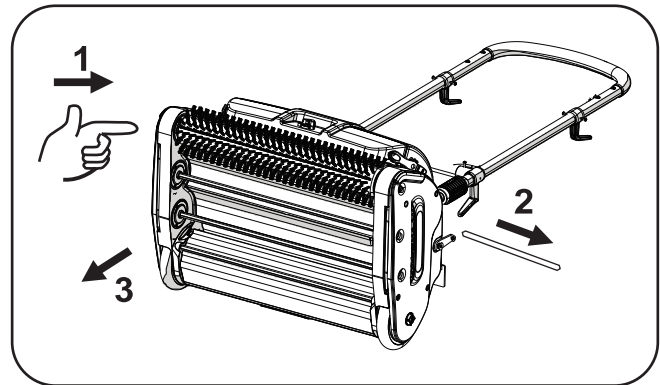

## BRUSH SELECTION:

### Caution:

After a pass or two, the carpet fibers have been fully agitated and the pile lifted. If additional cleaning of an area is required, allow fibers to dry, vacuum then repeat process.

**Continuous passes over the same area with any brush may damage the carpet fibers.**

### Use with caution.

Even the softest brush can cause damage if operated repeatedly in one area. The best advice is to be safe. In heavily matted/soiled areas, operate machine with overlapping passes, then operate at right-angle if possible. Do not use any more than two passes in each direction in a single cleaning operation. Repeated operations over a few days or weeks are sometimes necessary in situations where abuse and neglect (under cleaning or improper chemistry) have occurred. It is not acceptable in any situation to expect more of the machine and process than is seen in two passes in each direction.

COLOR	DESIGNATION	GENERALLY RECOMMENDED FOR	CAN BE USED FOR	CAUTIONARY STATEMENT
WHITE	SOFT	RESIDENTIAL, SOFT CUT PILE, BERBERS, WOOL, ORIENTAL, PERSIAN CARPETS	LIGHT TO MODERATE SOIL	USE WITH CAUTION
GRAY	SEMI-SOFT	RESIDENTIAL/COMMERCIAL	LIGHT TO MODERATE SOIL	USE WITH CAUTION
BLUE	SEMI-FIRM	COMMERCIAL	MODERATE SOIL, MATTED/CRUSHED	USE WITH CAUTION
GREEN	FIRM	COMMERCIAL	MODERATE TO HEAVY SOIL, HEAVILY MATTED PILE	USE WITH CAUTION

# Smart Care<sup>®</sup> TRIO CLEANING INSTRUCTIONS

## Cleaning Instructions:

- Mix Crystal<sup>®</sup> Dry Extra solution according to instructions on bottle.
- Run Smart Care<sup>®</sup> TRIO machine back and forth as you would a vacuum, or in straight rows as you would a lawn mover. For heavily soiled areas, run machine in 2 different directions (North/South then East/West).  
***Continuous passes over the same area with any brush may damage the carpet fibers. Use with caution.***
- A small amount of foam appears on most fiber types for 3-5 seconds before disappearing.
- For a uniform groomed look slightly overlap each backward pass.

Light Soiling:  
**One Pass**  
Like Lawnmower

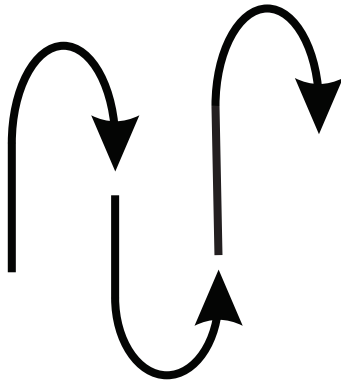

Moderate Soiling:  
**Two Passes**  
Like Vacuum



Heavy Soiling:  
**Multiple Passes**  
Like Vacuum in 2 Directions

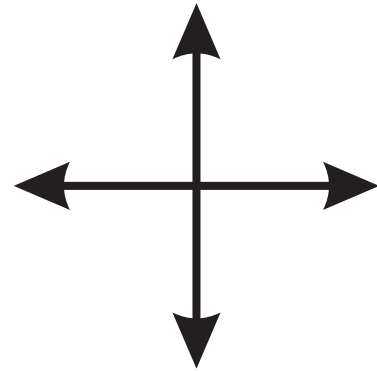

Note: After carpet is dry, in as little as 30 minutes, it may be vacuumed. However there is no need to vacuum immediately. The carpet is left bright and clean looking, with no visible “crystals”. Dirt becomes encapsulated in the dry crystals and is ready to be vacuumed at the next scheduled vacuuming. No residue is left to build up and clog carpets as with most dry compounds.

**Please remember all cleaning systems will be maximized with pre-vacuuming to remove larger dry particles of soil. For optimum results we suggest vacuuming thoroughly prior to cleaning.**

# MAINTENANCE

## During Operation:

- Rotate brushes every 2-3 hours of operation. This prolongs brush life and protects against gear damage.
- Do not lubricate axles. Keep clean and dry.
- Never rest machine with brushes directly on the floor.

## After Each Use:

- Unplug power cord at wall outlet.
- Remove, empty and rinse solution tank.
- Remove, empty and rinse collection hopper.
- Tilt machine backwards resting on its handle.
- Reach under with a finger and push axles sideways and out. No tools are required if machine is kept clean and brushes are rotated regularly.
- Remove brushes. Inspect for wear. Use the Brush Wear Indicator hole in one end of each axle to measure bristle length.
- Wipe underside of machine with damp cloth.
- Rotate the front brush end-to-end before replacing and do the same with the other 2 brushes.

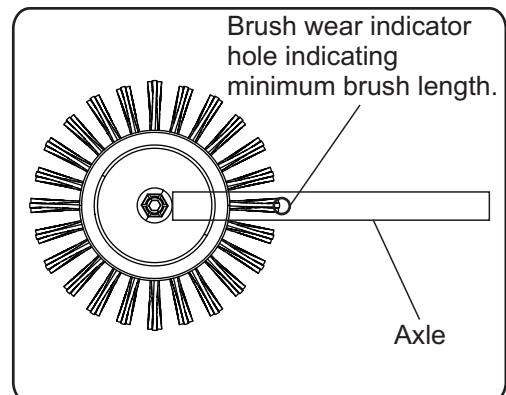
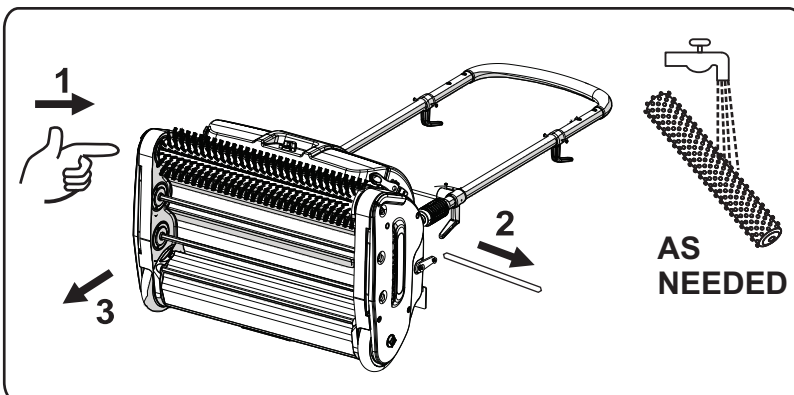
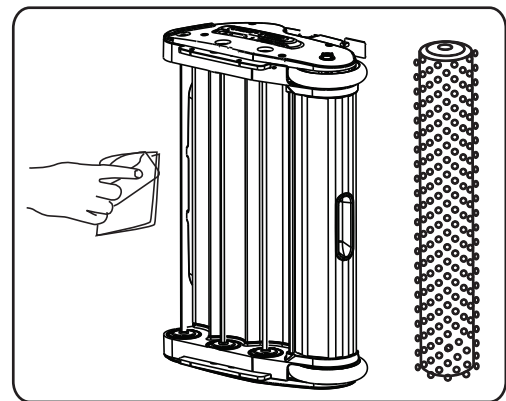
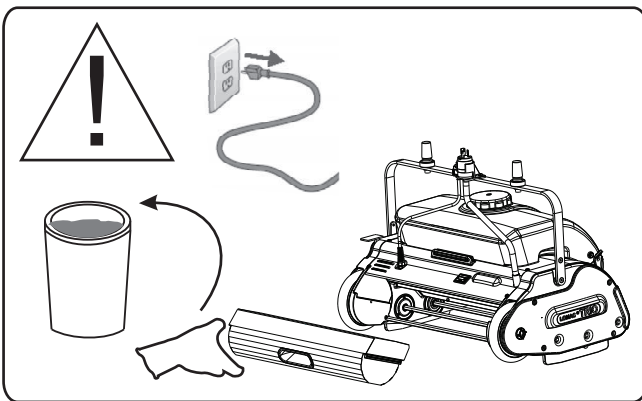



# TROUBLESHOOTING

## Problem

## Solution

**Machine does not start and makes no noise.**

- Wait 30 seconds if machine is warm. Push motor protector reset button. Use a small object to be sure to press it in far enough.
- Check electrical cords and connections for breaks.

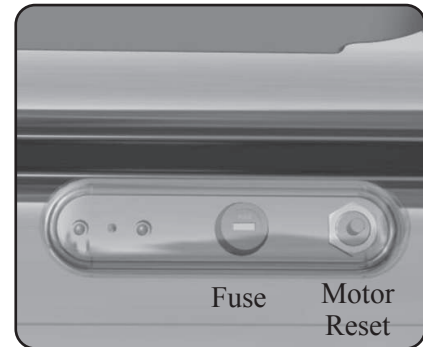

**Machine does not start and makes grunting noise.**

- Tilt machine toward the foot pedal side and allow brushes to rotate at full speed before lowering slowly onto the carpet.

**Only one brush turns.**

- One or more gears have stripped and need to be replaced before use.

**Machine bounces roughly when in use.**

- Inspect brushes for directional set from scrubbing in one direction too long.
  - Inspect axles and brush end caps for wear which will cause a vibration.
- HINT:** To prevent directional set, rotate the front brush end to end, and do the same with the other two brushes. Do this at day's end or after 2-4 hours of continuous use.

**Pump does not work.**

- Blown fuse or loose contact.

**To change fuse:**

- Unplug power cord from wall outlet.
- Remove the transparent protection cover.
- Remove the fuse holder cover with a screw driver.
- Remove the blown fuse.
- Insert a new fuse of the same rating.
- Put the cover back and check for function.

# TECHNICAL DETAILS

DESCRIPTION	UNIT	20 inch	15 inch
CLEANING CAPACITY(THEORETICAL) MIN	sq ft/hr (m <sup>2</sup> /hr)	6012-9036 (558-839)	4500-6768 (418-628)
CLEANING WIDTH	in (mm)	20.5 (515)	15.5 (390)
VOLTAGE (SINGLE PHASE)	V	110 ± 6%	110 ± 6%
FREQUENCY	Hz	60 ± 3%	60 ± 3%
POWER CONSUMPTION (MAX)	watts	1400	1100
CURRENT IN AMPS(MAX) WITH BRUSHES	A	14	11
CIRCUIT BREAKER RATING (MOTOR)	A	16	14
FUSE RATING (PUMP)	A	0.5	0.5
POWER CORD		3X14 AWG SJTOW	
NOISE LEVEL (MAX)	dB (A)	65	65
BRUSH SPEED - OUTER/CENTER	rpm	480/665	480/665
FRESH WATER TANK CAPACITY	gal (liters)	2.5 (9.5)	2.5 (9.5)
<b>OVER ALL DIMENSIONS:</b>			
HEIGHT WITH HANDLE	in (mm)	47.25 (1200)	47.25 (1200)
HEIGHT WITHOUT HANDLE	in (mm)	13.78 (480)	13.78 (480)
WIDTH	in (mm)	25.59 (650)	20.67 (525)
LENGTH	in (mm)	17.72 (450)	17.72 (450)
DRY WEIGHT	lbs (kg)	88.41 (33)	64.30 (24)
MAX LIFTING WEIGHT	lbs (kg)	80.37 (30)	61.62 (23)



# SAFETY ADVICE

## CAUTION - Safety Advice

 **This machine has rotating brushes.**

- Do not run over electrical, telephone or computer cables.
- Do not leave machine plugged in when unattended.
- Keep children away.
- Ensure handle is in upright position and lock is working correctly prior to connecting to power supply.
- Do not run machine over loose carpet fibers or edges of rugs or carpet matting.
- Always test clean an area when cleaning a different carpet or after changing to different brushes.

### Electrical:

- Disconnect power cord at wall outlet before changing brushes, lifting machine off floor or servicing.
- Keep away from water.
- Inspect power cord prior to each use for abrasion or cuts. If cuts are found replace cord before use.
- This machine shall be grounded while in use to protect the operator from electric shock. The machine is provided with a three-conductor cord and a three-contact grounding type attachment plug as in below sketch. The green (or green and yellow) conductor in the cord is the grounding wire. Never connect this wire to other than the grounding pin of the attachment plug.

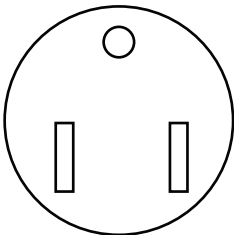

**Main plug: NEMA 5 -15 P**



**Interconnecting receptacle : NEMA L5 -15 R**

*Continuous passes over the same area with any brush may damage the carpet fibers.  
Use with caution*

**IT IS THE USER'S RESPONSIBILITY TO OPERATE THIS  
APPLIANCE SAFELY AND CAREFULLY.**

○○○ **PROGENTA**